



# Quick Operation manual for The Golf Watch mk2 and mk2+



**!** Please charge fully before the play. (Full charge takes About 3 hours)

**1** When you arrive at the golf course, push MENU key and show the menu page.



**2** Select "GPS caddie" (top line) by OK key then GPS caddie mode menu shows up. Select "Full auto play" (top line) by OK key.



**3** The Golf Watch start to acquire GPS signal. It would take maximum 10 minutes to complete it. Then the Golf Watch search for golf courses nearby (2nd image). Then the Watch requests you to move to the starting hole (3rd image). When the golf Watch find a tee ground, it ask you if this is your starting hole (4th image). If yes, approve it by OK key. If not, move to your starting tee ground.

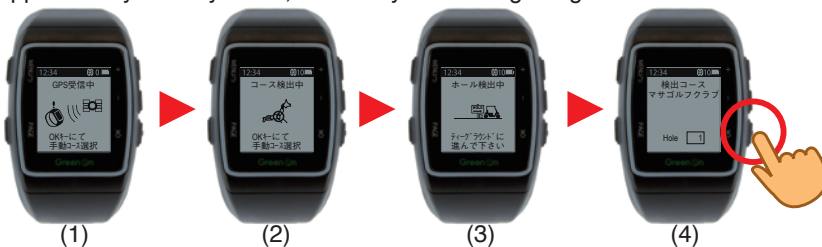

**4** Now GPS caddie start. 2nd line of the top page show the distance to the green center or to the pin (to show the distance to the pin, it needs pin position setting in advance at MENU page). 3rd line shows the drive distance or the distance to the green front or to the green back. It is switched by keying OK button. Plus/minus keys are for score count. To measure the drive distance, you have to push the plus key at your swing position then the drive distance show on the 3rd line when you reach at the ball position. By keying PAGE key, you can see the distance to hazards. Further keying of PAGE key switch the page to the Green attack page. When you move to the next hole tee ground, the watch automatically notice the new tee ground and data show the value for this hole.

**MENU Key**

**PAGE Key**

**+ Key、- Key score counter**

**OK Key switched by keying OK button.**

**Green attack screen (only mark2plus)**

**Hazard screen**

**348 Front**

**367 Back**

**5** After the end of the round, select "Exit GPS caddie [プレイ終了]" in Menu page and press the OK key to complete the GPS caddie.

